

CHAPTER 16

INTEGRITY WOOD-ULTREX and ALL ULTREX ACCESSORIES

Wood-Ultrex Installation Bracket and Nailing Fin	16.2
Wood-Ultrex Interior Accessories	16.3
All Ultrex Installation and Nailing Fin	16.4
All Ultrex Exterior Accessories	16.5
All Ultrex Interior Accessories	16.6
Wood-Ultrex and All Ultrex Exterior Casing Elevations	16.7
Wood-Ultrex and All Ultrex Exterior Casing Profiles and Parts	16.8
Wood-Ultrex and All Ultrex Exterior Casing Conversions	16.9
Wood-Ultrex and All Ultrex Casing Applications for Windows	16.10
Wood-Ultrex and All Ultrex Casing Applications for Doors	16.11

ATTENTION:

- Specifications and technical data are subject to change without notice.
- Allow 1/16" (1.59 mm) tolerance on all measurements.
- Interior mullion trim shipped loose for field installation.
- For answers to technical questions about Integrity products you may call our Integrity Support Line: 1-800-587-2712.
- Website: www.integritywindows.com

Wood-Ultrex Installation Brackets and Nailing Fin

Installation Brackets

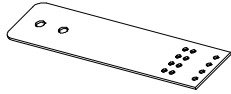

Integrity Structural Bracket

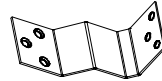

Installation Clip

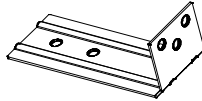
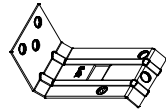
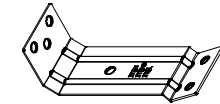
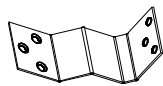

Nail Fin Installation Kit - Impact

Nailing Fin / Drip Cap

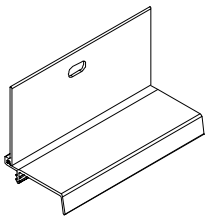

Head Jamb Nailing Fin/Drip Cap

V119

Note: Drip cap is clear

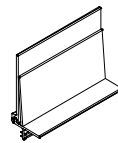

Radius Head Jamb Nailing Fin/Drip Cap

V110

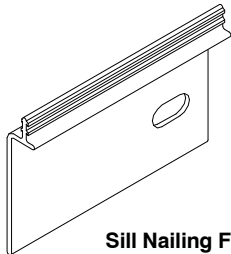

Sill Nailing Fin

V084

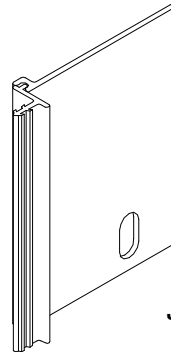

Jamb Nailing Fin

V104

Wood-Ultrex Interior Accessories

Jamb Extension

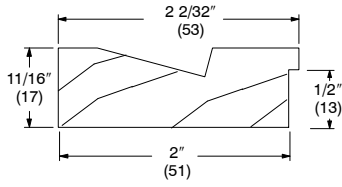

6 9/16" Jamb Extension
W7432

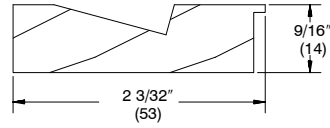

IIFD to Direct Glaze Jamb
6 9/16" Jamb Extension
W7119

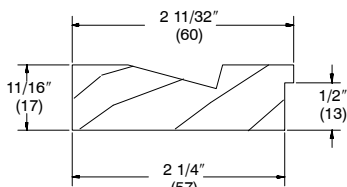

6 13/16" Jamb Extension
W7446

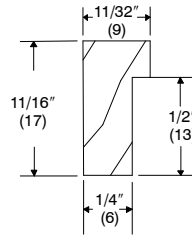

IIFD 1/4" Jamb Extension for 6 13/16"
W2214

Interior Mullion Trim

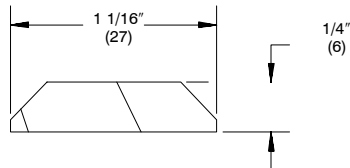

Interior Mullion Trim
W1241

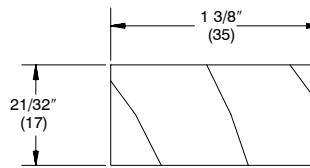

ICA Mullion Filler Block
W6172

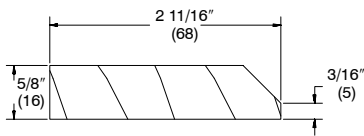

ICA Wood Mullion Tie
W7004

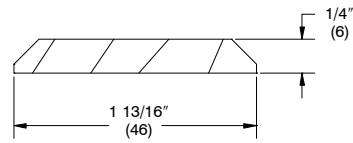

Horizontal Mull Trim
W9159

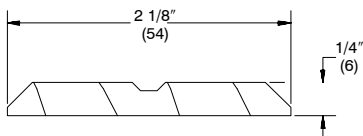

Interior Mullion Trim
W1243

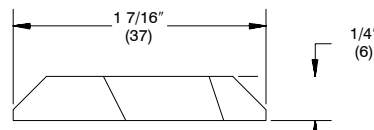

Interior Mullion Trim
W1242

All Ultrex Installation Brackets and Nailing Fin

Installation Bracket

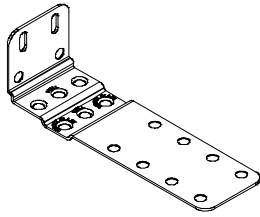

4 9/16" Structural Brackets

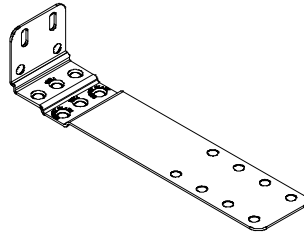

6 9/16" Structural Brackets

Nailing Fin / Drip Cap

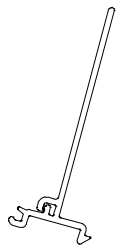

Nailing Fin - Windows and Doors
V1428

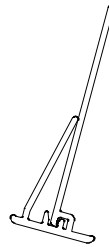

Nailing Fin - Radius
V2067

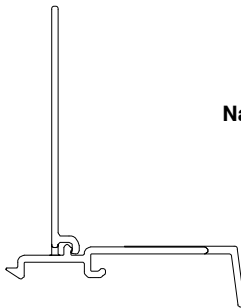

Nailing Fin with Drip Cap -
Windows and Doors
V2395

All Ultrex Exterior Accessories

Frame Expander

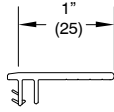

1" Frame Expander
V2034

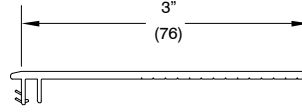

3" Frame Expander
V1780

Flush Fin

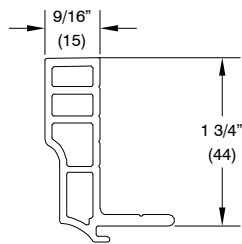

Flush Fin
V2056 - 1 3/4" Flush Fin

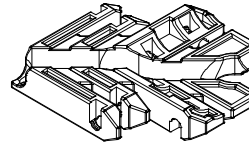

Flush Fin Corner Key

J-Channel

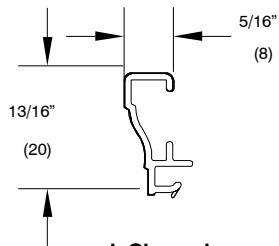

**J-Channel
Head Jamb and Jamb**
V1458

Note: Mitered Corners

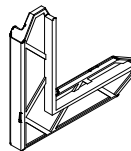

J-Channel Corner Key

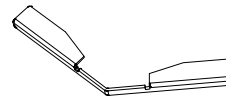

**J-Channel Corner Key,
Adjustable**

All Ultrex Interior Accessories

Jamb Extension

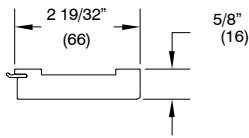

4 9/16" Jamb Extension – Window
V1563

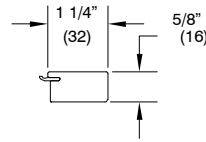

4 9/16" Door Jamb Extension
V1641

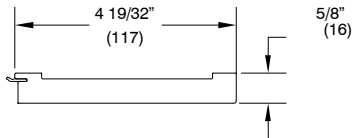

6 9/16" Jamb Extension – Window
V1578

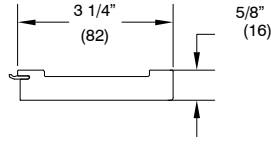

6 9/16" Door Jamb Extension
V1640

Drywall Return and Receiver

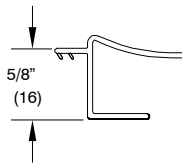

1/2" to 5/8" Drywall Return
V1401

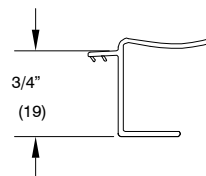

3/4" Receiver
V1710

Interior Frame Filler

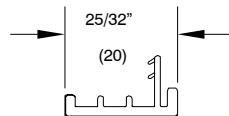

Interior Frame Filler
V2053

Wood-Ultrex and All Ultrex Exterior Casing Elevations

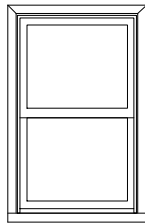

**BMC - Flush
With Sill Nosing**

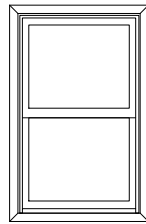

**BMC - Mitered
Casing Four Sides**

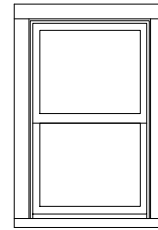

**Flat Casing- Flush
With Sill Nosing**

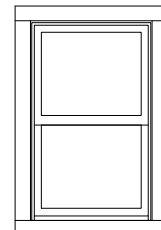

**Flat Casing- Flush
Casing Four Sides**

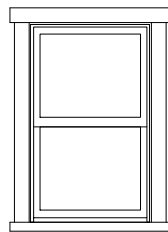

**Flat Casing- Ranch Style
With Sill Nosing**

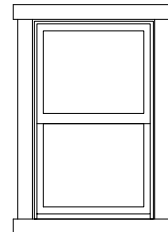

**Flat Casing- Ranch Style
Casing Four Sides**

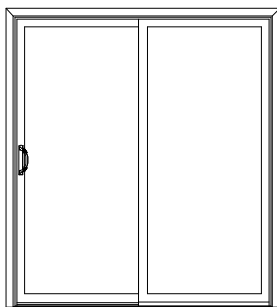

BMC

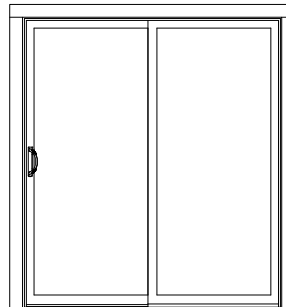

Flat

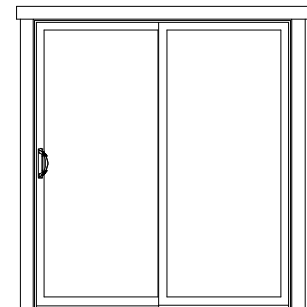

Ranch Style

NOTE: Ranch Style casing overhangs each side by 1" (25)

Wood-Ultrex and All Ultrex Exterior Casing Profiles and Parts

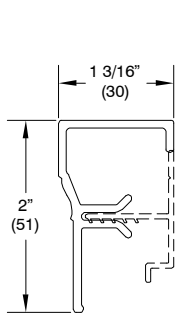

F9105
BMC - 2"

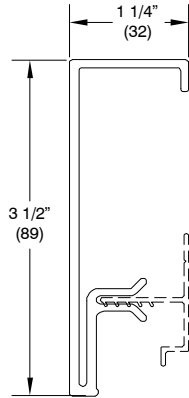

F9108
Flat Casing - 3.5"

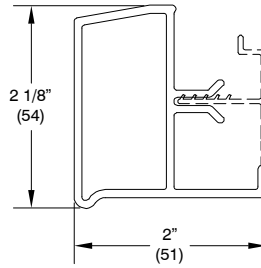

F9107
Sill Nosing - 2"

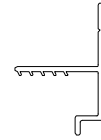

V2177
Connection Barb

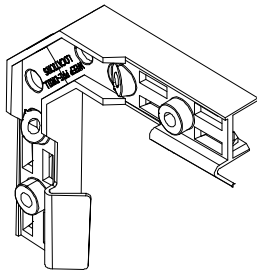

Exterior Casing
Corner Key

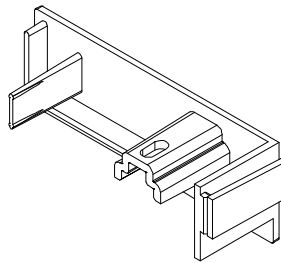

End Cap
Flat Casing, 3.5"

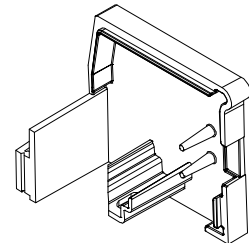

End Cap
Sill



#7 X .750" Type A-17 PH full thread



Reticulated Foam
.625" X .625"

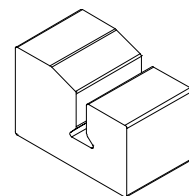

BMC
Plug

Wood-Ultrex and All Ultrex Exterior Casing Measurement Conversions

Frame Outside Measurement to Exterior Casing Individual Part Finished Overall Length		
Windows		
Exterior Casing Configuration	Part	Conversion
BMC (all four sides)	Header & Sill	+ 3 3/8"
	Jambs	+ 3 3/8"
BMC w/ Sill Nosing	Header	+ 3 3/8"
	Sill	+ 2 7/8"
	Jambs	+ 1 3/8"
3.5" Flat Casing (all four sides)	Header & Sill	+ 6 7/32"
	Jambs	- 5/8"
3.5" Flat Casing w/ Sill Nosing	Header	+ 6 7/32"
	Sill	+ 5 7/8"
	Jambs	- 5/8"
3.5" Flat Casing – Ranch Style	Header & Sill	+ 8 7/32"
	Jambs	- 5/8"
3.5" Flat Casing – Ranch Style w/ Sill Nosing	Header	+ 8 7/32"
	Sill	+ 7 7/8"
	Jambs	- 5/8"
Doors		
Exterior Casing Configuration	Part	Conversion
BMC (all four sides)	Header	+ 3 3/8"
	Jambs	+ 1 11/16"
3.5" Flat Casing (all four sides)	Header	+ 6 7/32"
	Jambs	- 3/8"
3.5" Flat Casing – Ranch Style	Header	+ 8 7/32"
	Jambs	- 3/8"

Frame Outside Measurement to Exterior Casing Outside Measurement Conversion		
Windows		
Exterior Casing Configuration	Width	Height
BMC (all four sides)	+ 3 3/8"	+ 3 3/8"
BMC w/ Sill Nosing	+ 3 3/8"	+ 3 3/8"
3.5" Flat Casing (all four sides)	+ 6 3/8"	+ 6 3/8"
3.5" Flat Casing w/ Sill Nosing	+ 6 3/8"	+ 4 7/8"
3.5" Flat Casing – Ranch Style	+ 8 3/8" *	+ 6 3/8"
3.5" Flat Casing – Ranch Style w/ Sill Nosing	+ 8 3/8" *	+ 4 7/8"
*Note: Ranch Style header & sill overhang the jambs & do not have square or rectangle outer shape – see diagrams on page 16.7		
Doors		
Exterior Casing Configuration	Width	Height
BMC (header & jambs)	+ 3 3/8"	+ 1 11/16"
3.5" Flat Casing (header & jambs)	+ 6 3/8"	+ 3 3/16"
3.5" Flat Casing – Ranch Style (header & jambs)	+ 8 3/8" *	+ 3 3/16"
*Note: Ranch Style header overhangs each jamb & does not have square or rectangle outer shape – see diagrams on page 16.7		

NOTE: Installation requires a minimum of 1 inch (25). Projections greater than 1 inch (25) may require connection bars to be shimmed away from sheeting for compensation.

Wood-Ultrex and All Ultrex Exterior Exterior Casing Applications for Windows

IDH Polygon with BMC and Sill Casing

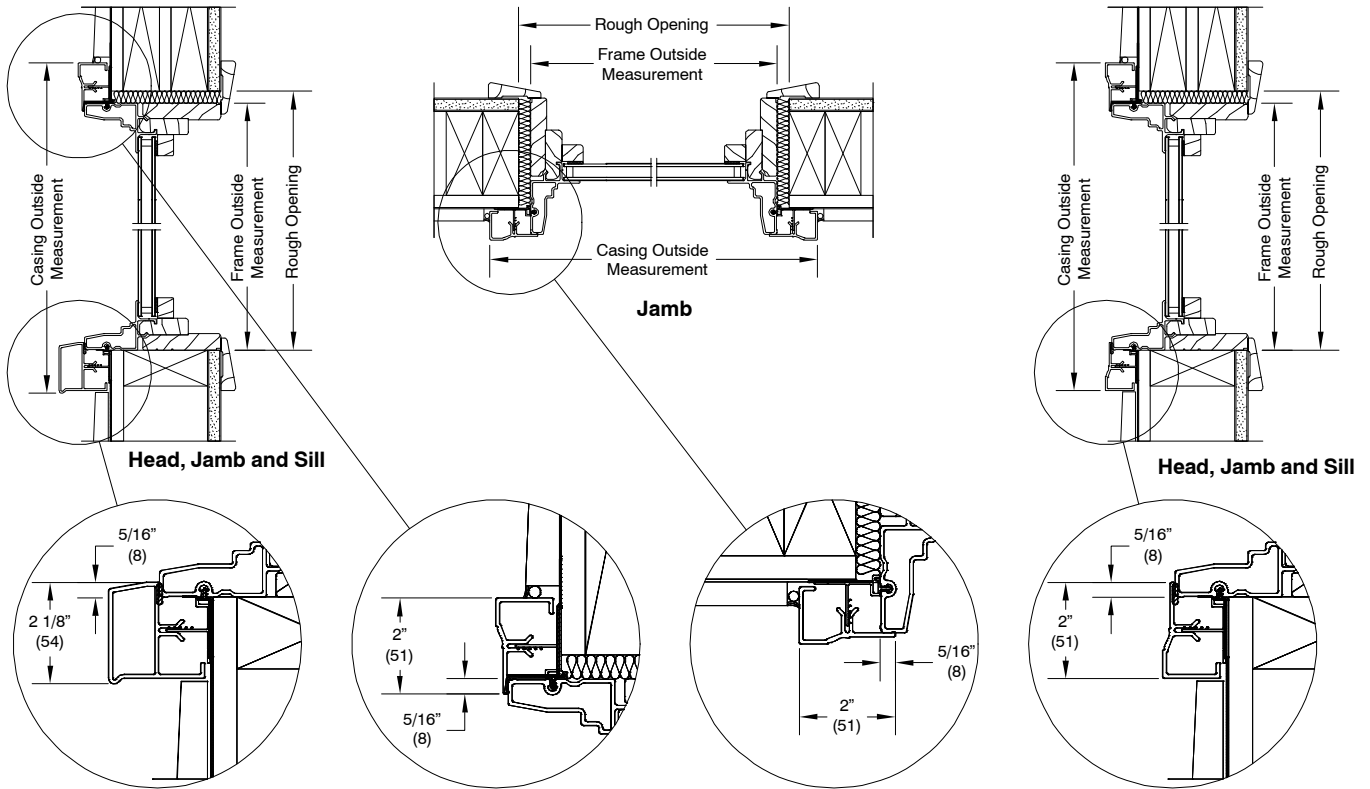

IDH Polygon with Flat Casing and Sill Casing

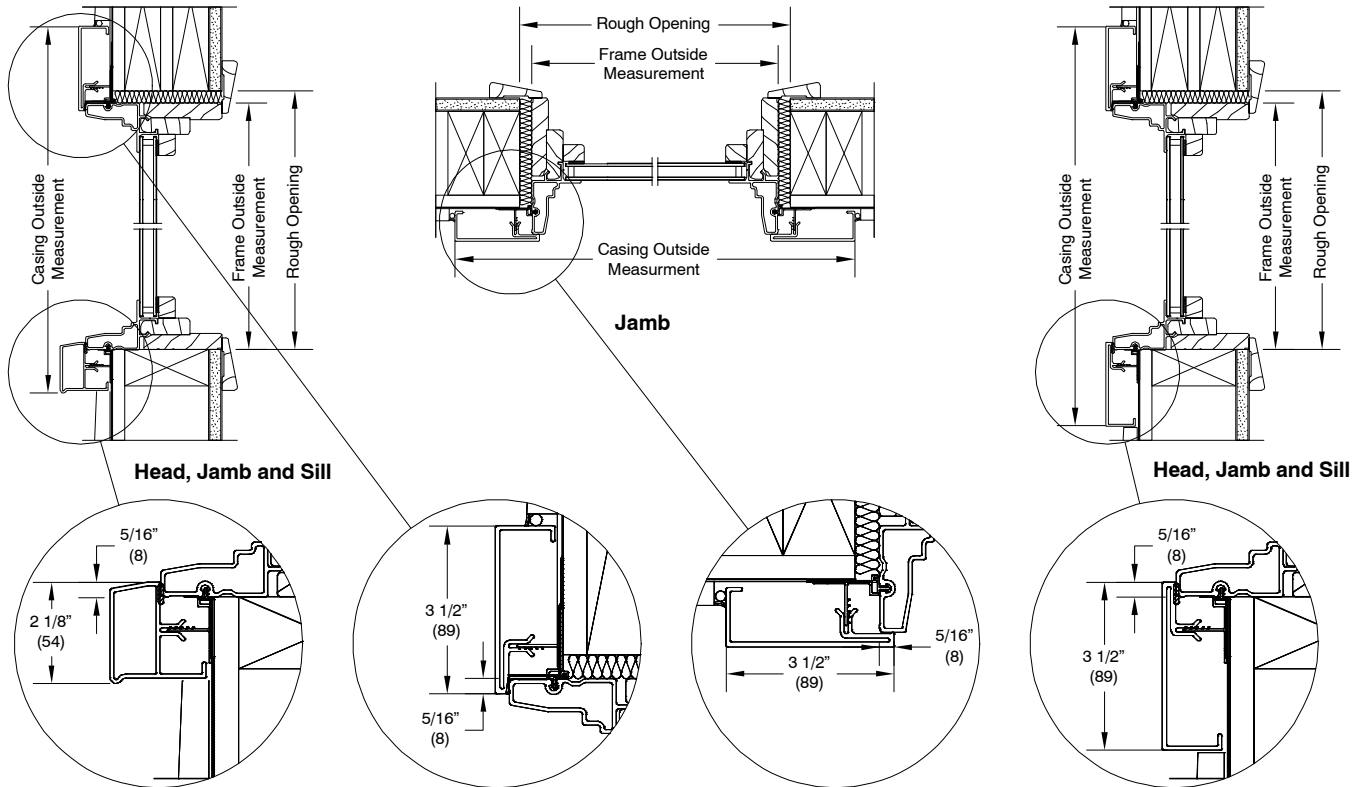

Wood-Ultrex and All Ultrex Exterior Casing Applications for Doors

ISFD with BMC

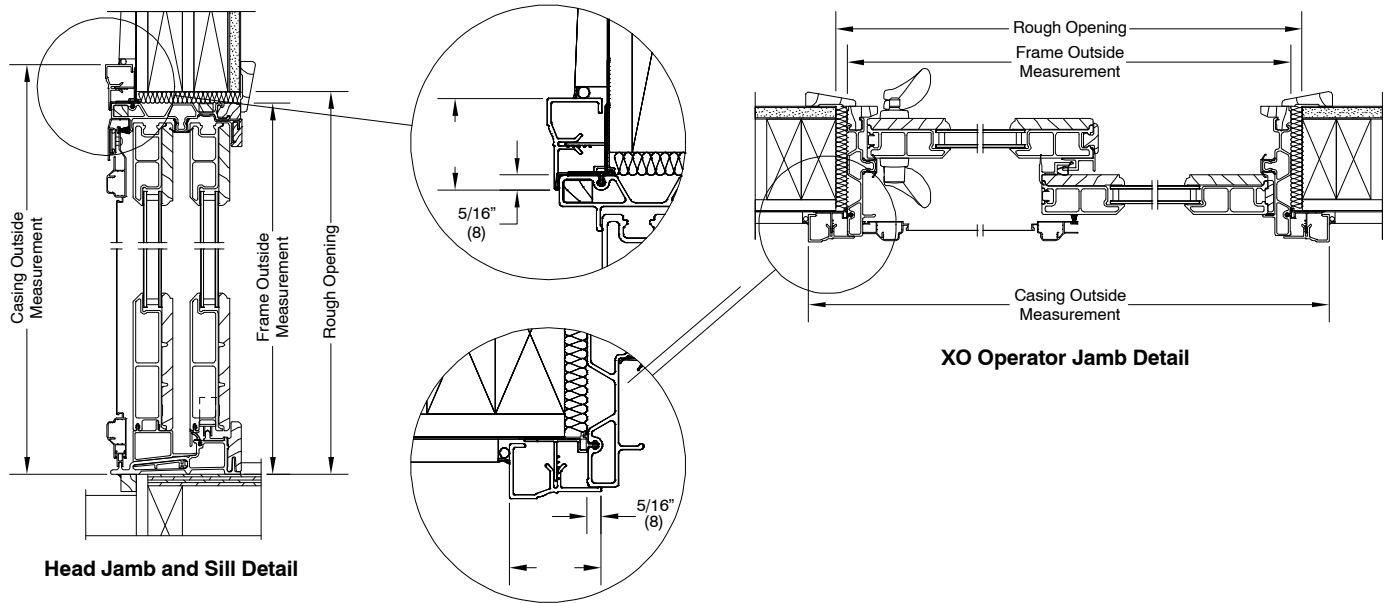

ISFD with Flat Casing

